

*F*or your most precious possession...

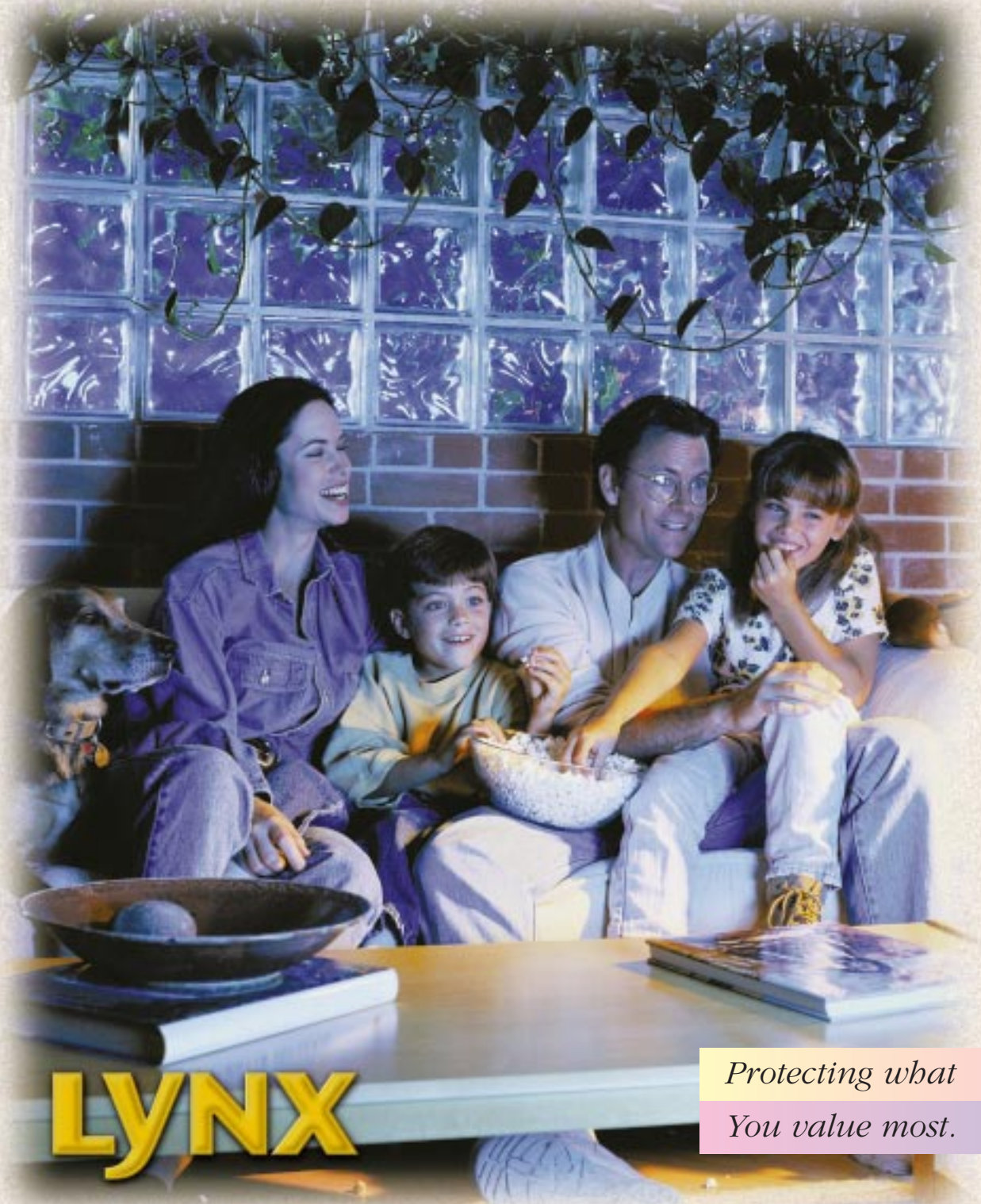

**LYNX**

*Protecting what  
You value most.*

...the security of your family & home.

**ADEMCO  
GROUP**

# We've been protecting the homes of families like yours for more than 65 years.

It's no wonder so many families are at home with ADEMCO products. As the world's largest manufacturer of electronic security products and systems, we build over 65 years of proven performance into everything we make. As industry pioneers, ADEMCO developed many of the technologies that have shaped today's home security systems.

## We developed Lynx by Listening

Peace of mind comes in many forms... sleeping easy in a home that's electronically secured; entering a well-lit house; knowing your kids have arrived home safely from school. By really listening to our customers we've learned that your peace of mind is what matters most. That's what drives ADEMCO to bring you security products like LYNX that provide security and convenience to fit your busy lifestyle.



**1** The user-friendly LYNX puts optimum security at your family's fingertips. Features include a full 16 button keypad, an easy to read LCD display and a voice response system that speaks to you in plain English.



**2** The sleek all-in-one unit can be placed on a wall or tabletop. Because LYNX is wireless, installation is quick, clean and efficient.

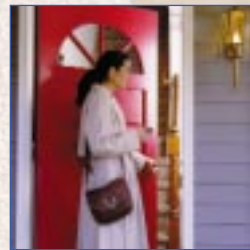

**3** Control your security system, appliances – even lights – with our convenient wireless keys. One-button operation eliminates the need to remember codes.

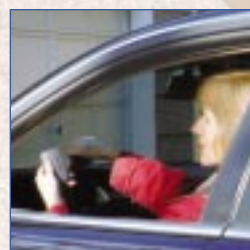

**4** Enhanced wireless keys give you the convenience and power of two-way feedback. With the press of a button, you can confirm system status and operate appliances.

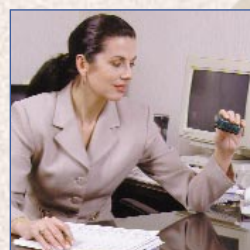

**5** LYNX can send a message to your numeric pager to let you know your kids have arrived home safely from school when they disarm the system. LYNX can also page you with the touch of a button.

**6** Reliable, wireless smoke and heat detectors protect your home from trouble before it gets out of control.

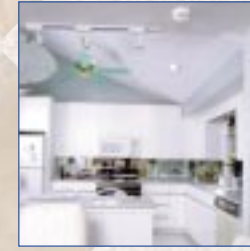

**7** Protect larger areas, or provide a second level of security, with advanced passive infrared motion detectors. Protect windows with compact shatter and shock sensors.

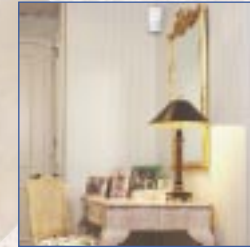

**8** In the event of an alarm, LYNX transmits a message to a central station. Your home is monitored – 24 hours a day.

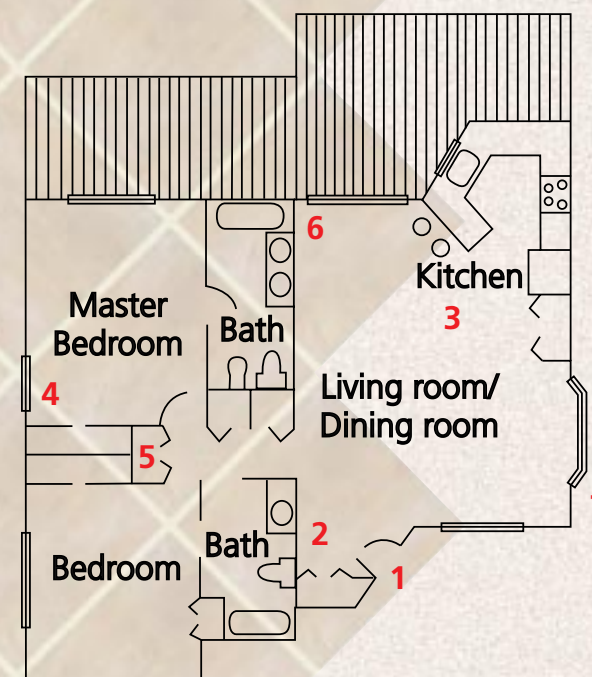
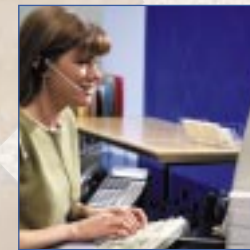

## Making Home Security Simple and Convenient

LYNX combines advanced security with a wide range of convenient and home automation features that will make everyday life a little easier for you and your family. When you're protected by LYNX, you get much more than peace of mind.



## Bringing you the highest level of quality

When it comes to home security, trust LYNX to protect your most precious possession of all...the security of your family.



165 Eileen Way • Syosset, NY 11791 • phone: 1-800-573-0154 • [www.ademco.com](http://www.ademco.com)